



STAINLESS STEEL TRIM KITS FOR MEDIUM-DUTY TRUCKS (MODEL RW8182 & RW8183)

VERY IMPORTANT! Read And Understand These Steps Before Installation.



PHOTO 1A



PHOTO 1B



PHOTO 1C



PHOTO 1D



PHOTO 1E

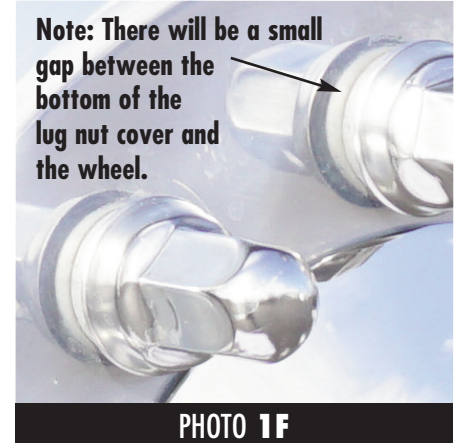

Note: There will be a small gap between the bottom of the lug nut cover and the wheel.

PHOTO 1F

Installing the Front Baby Moon Trim Kit

- Photo 1A shows the notches between the pilots on the front hub.
- Place the front baby moon at an angle into the front hub so that three of the rear tabs on the backside of the baby moon fit between three notches in the hub. (See Photo 1B)
- Next lower the baby moon into position. You may need to slightly push in the two remaining tabs on the rear of the baby moon until they clear the rim. (See Photo 1C)
- Now gently tap on the baby moon with the bottom of your fist until it flush to the face of the rim. (See Photo 1D)
- Place the lug nut covers over the lug nuts and push firmly into place. (See Photo 1E)
Note: There will be a small gap between the bottom of the lug nut cover and the wheel. (See Photo 1F)
- Repeat the same process on the other wheel and you're finished. (See Photo 1G)



PHOTO 1G



PHOTO 1H

To Remove: Locate the small indented slot in the rim of the baby moon. Carefully insert a flat head screwdriver into the slot and work the baby moon loose. (See Photo 1H)

See back for installation of Rear Wheel Trim Kit.

STAINLESS STEEL TRIM KITS FOR MEDIUM-DUTY TRUCKS (MODEL RW8182 & RW8183)



PHOTO 2A



PHOTO 2B



PHOTO 2C



PHOTO 2D

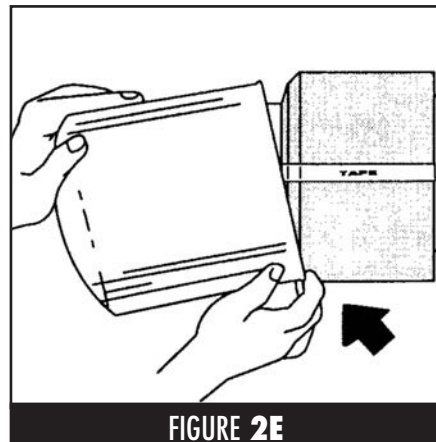

FIGURE 2E

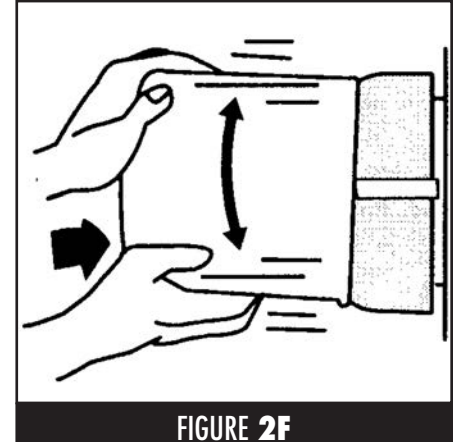

FIGURE 2F

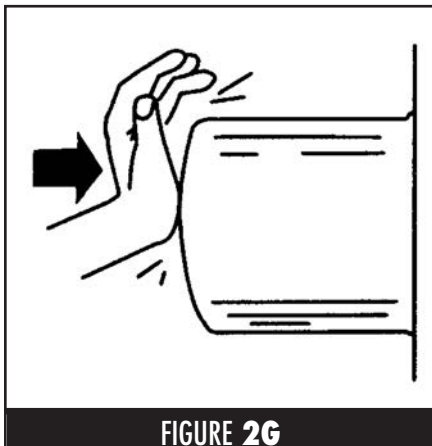

FIGURE 2G



PHOTO 2H

Note: There will be a small gap between the bottom of the lug nut cover and the wheel.



PHOTO 2I

Installing the Rear High Hat Trim Kit

- Install foam ring over axle hub and slide all the way back. (See Photos 2A & 2B)
- Install tape strips to hold foam in place during installation of high hats. Attach tape to one side of foam, push down on foam and bring tape across front of axle hub. Push down foam and attach tape to other side. Repeat process for second strip of tape. (See Photos 2C & 2D)
- To install high hat over the foam ring, start by sliding high hat over foam from bottom side. (See Figure 2E) Next, holding high hat firmly with one hand, tuck foam into high hat with the other hand all the way around the ring until entire ring has started to feed into high hat.

- With both hands on each side of the high hat, use a slight twisting and wobbling motion pushing high hat over foam until it has seated against the wheel. (See Figure 2F) **Note:** If foam shows a slight bulge between wheel and high hat, back up a little and use an up and down and side to side motion until foam completely slides under high hat. Using the palm of your hands make sure the high hat is firmly against the wheels. (See Figure 2G)
 - Place the lug nut covers over the lug nuts and push firmly into place. (Photo 2H) **Note:** There will be a small gap between the bottom of the lug nut cover and the wheel.
 - Repeat the same process on the other wheel and you're finished. (Photo 2I)
- To Remove:** To remove high hats, use a twisting and pulling motion.

RealWheels Corporation • 3940 Tannahill Drive • Gurnee, IL 60031

847-662-7722 • Fax 847-662-7744 • www.realwheels.com • info@realwheels.com • toll-free 1-800-982-1180