



INSTALLATION OF WHEEL COVERS FOR TRUCKS & TRAILERS WITH STEEL DISC AND CAST SPOKE (DAYTON) WHEELS

VERY IMPORTANT!

Read And Understand These Steps Before Installation.

TOOLS NEEDED

Standard Screwdriver or 5/16" Nut Driver

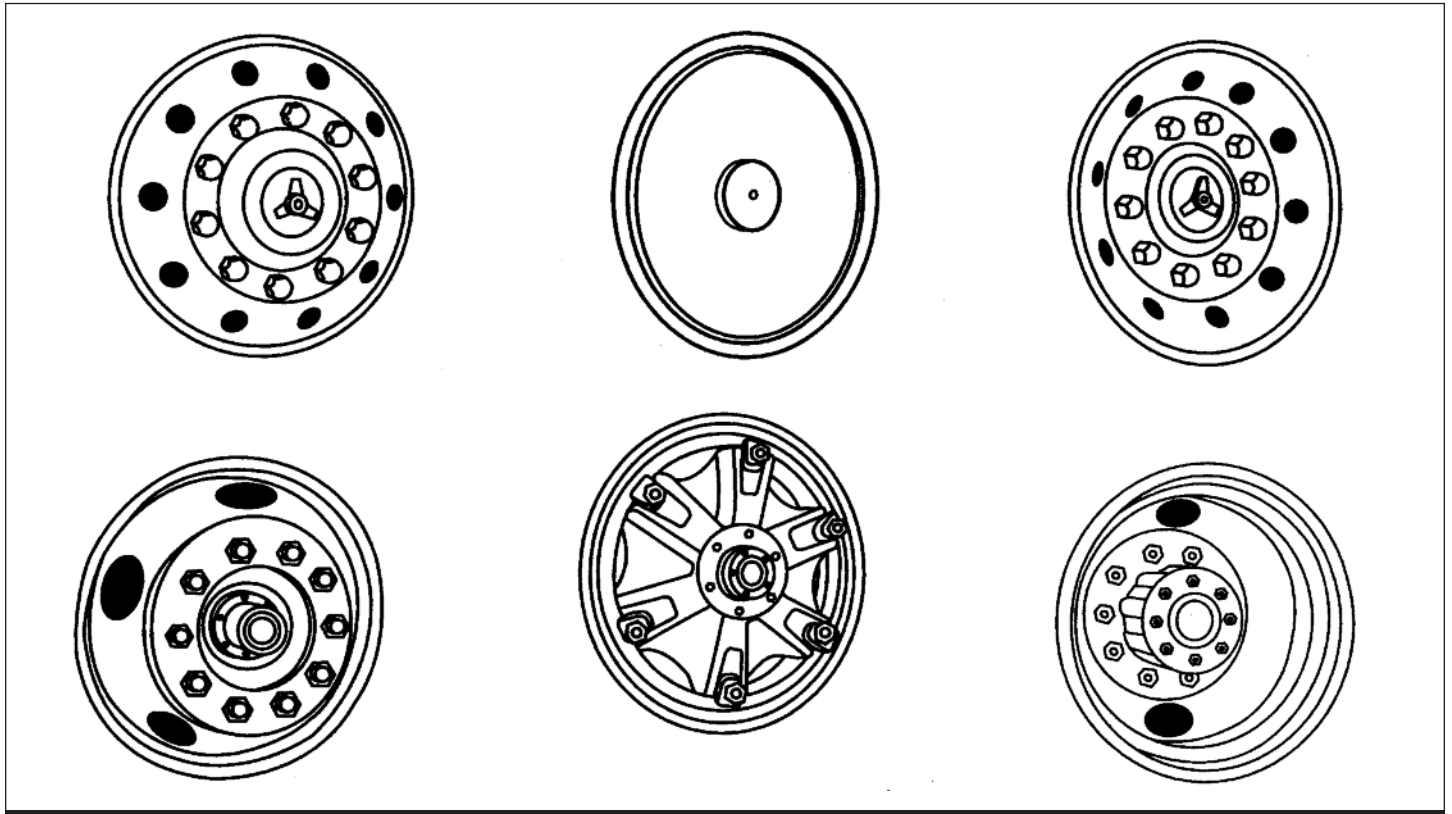

CMS - CENTER MOUNT SYSTEMS

EACH MOUNTING KIT CONTAINS THE FOLLOWING PARTS

RW0340

- 2 - Key Wrench
- 2 - Locking Screws
- 2 - Locking Screw Washers
- 2 - Chrome Wing Nuts
- 4 - 1/2" Lock Washers
- 2 - 1/2" Flat Washers
- 8 - 1/2" Jam Nuts
- 2 - Center Mount Plates
- 4 - 7/16" Lock Washers
- 2 - Threaded Center Studs
- 4 - 1/2" Tube Extensions
- 4 - 1 1/2" Tube Extensions

RW0510

- 2 - Key Wrench
- 2 - Locking Screws
- 2 - Locking Screw Washers
- 2 - Chrome Wing Nuts
- 4 - 1/2" Lock Washers
- 2 - 1/2" Flat Washers
- 10 - 1/2" Jam Nuts
- 2 - Center Mount Plates
- 4 - Mounting Legs
- 8 - Keps Nuts
- 8 - Carriage Bolts
- 2 - Threaded Center Studs

RW6600

- 2 - Key Wrench
- 2 - Locking Screws
- 2 - Locking Screw Washers
- 2 - Stainless Steel Center Plates
- 4 - Wheel Cover Mounting Bolts
- 4 - 1/2" Lock Washers
- 2 - 1/2" Flat Washers
- 8 - 1/2" Jam Nuts
- 2 - Threaded Center Studs
- 2 - Axle Mount Assemblies

RWUK200

- 2 - Key Wrench
- 10 - 1/2" Jam Nuts
- 2 - Locking Screws
- 2 - Chrome Wing Nuts
- 4 - 1/2" Lock Washers
- 2 - 1/2" Flat Washers
- 2 - Locking Screw Washers
- 2 - Threaded Center Studs
- 2 - Center Mount Plates
- 4 - Mounting Legs

RW0511

- 2 - Locking Screw Washers
- 2 - Stainless Steel Center Plates
- 4 - Wheel Cover Mounting Bolts
- 2 - Threaded Center Studs
- 4 - 1/2" Lock Washers
- 10 - 1/2" Jam Nuts
- 2 - Key Wrench
- 4 - Mounting Legs
- 2 - Locking Screws

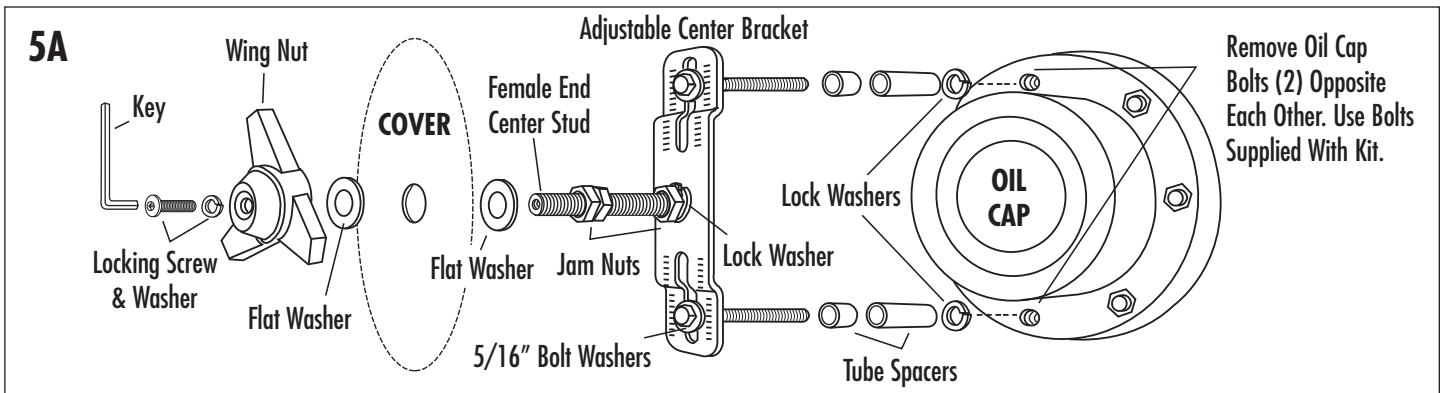

FIGURE A — RW0340 FRONT

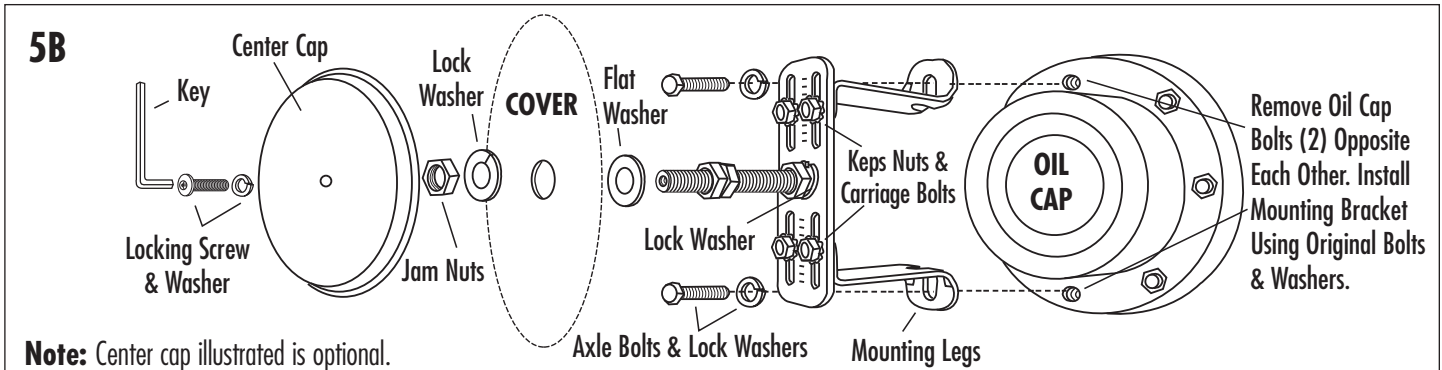

FIGURE B — RW0510 TRAILERS

Figure A: Illustrates A Typical Front Wheel Cover Center Mount System.

Figure B: Illustrates A Typical Trailer Wheel Cover Center Mount System.

Step 1:

INSTALLING RW0340 - REFER TO FIGURE A
INSTALLING RW0510 - REFER TO FIGURE B

Figure A: RW0340 Mounting W/Tube Extensions

Looking at (Figure A), remove two (2) opposing bolts from oil or grease cap. Next, using 5/16" bolts and washer supplied with kit, slide one through each side of mounting bracket.

Next, slide extension tubes on from bottom of mounting bracket (See Figure A) and place assembly over oil or grease cap to see how it fits; if more height is needed, add 1/2" spacers to the tube. Next, line up slots in mounting bracket with bolt holes and adjust slide plate so it is exactly centered by referring to centering lines on mounting plate. CHECK bottom of bracket to make sure it is not touching oil cap; if it is touching, add spacers, or re-adjust threaded center stud. Next, tighten assembly securely to oil or grease hub.

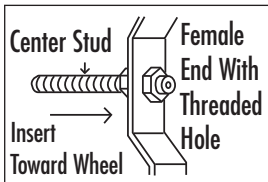

ILLUSTRATION 1

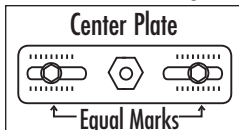

ILLUSTRATION 2

Figure B: RW0510 Mounting w/Standing Legs

When mounting wheel covers using standing legs, attach four (4) 1/4" carriage screws through standing legs to center bracket with "keps nuts" facing out (see Figure B). This will allow for easier adjustment. Next, place mounting bracket over axle hub and use original bolts and washers, attach to axle hub loosely. Line up slots in mounting bracket and make sure it is not touching axle hub (if touching, adjust accordingly). Next, tighten all nuts and bolts securely. Please see footnote before proceeding.

STEP 2: Installing Wheel Cover (RW0340 or RW0510)

Place wheel cover over center stud making sure the cover is firmly against the wheel rim, mark stud 3/4" out from the wheel cover center hole. Double check to make sure you have marked solid end of center stud. (See Illustration 4 & 5).

STEP 3: (RW0340 or RW0510)

Remove wheel cover and cut stud at mark using hack saw. Next, remove threaded stud from mounting plate and turn it around so that the female side (end with the center screw) is now facing to the outside. Re-assemble and tighten all nuts and bolts.

STEP 4: (RW0340 OR RW0510)

Place two (2) - 1/2" jam nuts on stud and a 1/2" flat washer so that the distance between the end of

the stud and the top of the washer is 3/4". Tighten jam nuts together. Place wheel cover over stud (there should be a 1/4" gap behind the cover). Before proceeding to next step make sure wheel cover is centered and firmly against the outer part of the wheel (if the wheel cover does not seem tight enough against the wheel, jam nuts may need to be re-adjusted).

STEP 5A: Installing Wing Nut

If you are installing WING NUT - place flat washer over stud and screw wing nut on until tight. Next, install locking screw through top of wing nut and tighten locking screw with locking key. **Note:** Tamper proof systems use left hand threaded locking screws.

STEP 5B: Installing Center Cap

If you are installing CENTER CAP, install 1/2" lock washer and nut over wheel cover and tighten securely. Next, place center cap over stud and use locking key to secure left handed locking screw to cover.

IMPORTANT NOTE:

PLACE A SMALL AMOUNT OF GREASE ON THE LOCKING SCREW BEFORE TIGHTENING. THIS WILL PREVENT THE LOCKING SCREW FROM CEASING UP IN THE STUD.

Note: Center cap illustrated is optional.

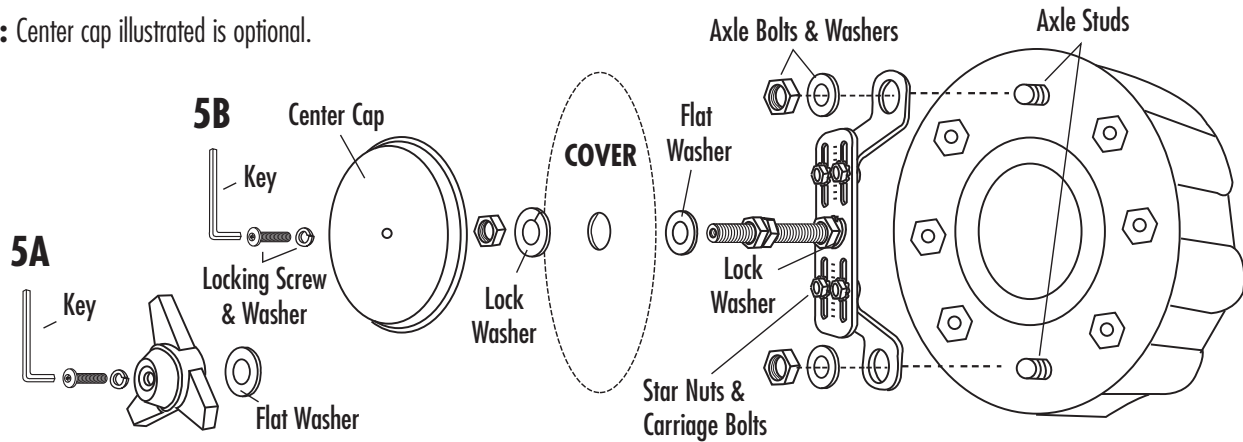

FIGURE C — RWUK200 REAR DRIVE AXLE

Figure C illustrates a typical installation of rear wheel cover on drive axles. Also note that there are two (2) decorative styles, as illustrated in Figure C: (Wing Nut or Center Cap) that can be used with center mount bracketing systems.

FIGURE C: Installing RWUK200

STEP 1:

Remove two (2) opposing nuts from axle hub. Place slide bracket assembly over axle. Replace lock washers and nuts (do not tighten). **Caution:** If axle studs are smaller than 3/4" - place "washer reducer" into the 3/4" hole in bracket legs. Next, adjust center bracket plate so there is an equal amount of lines on both sides. Tighten star nuts on slide bracket.

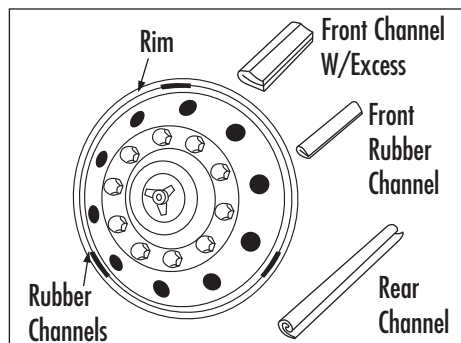

ILLUSTRATION 3 — Installation Of Rubber Channels

BEFORE PROCEEDING TO STEP 2 Make sure rubber channels have been placed evenly around "outside edge" of cover (between rim and cover). See Illustration 3.

STEP 2: Installing Wheel Covers

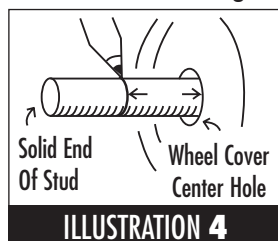

ILLUSTRATION 4

Place wheel cover over center stud making sure cover is firm against wheel rim. With a marker and ruler,

mark stud 3/4" out from the wheel cover center hole. Double Check mark and make sure solid end of stud is protruding through cover (See Illustration 4).

STEP 3:

Remove wheel cover and cut stud at mark using hack saw (See Illustration 5).

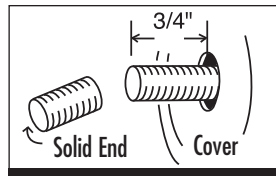

ILLUSTRATION 5

Next, remove threaded stud from mounting plate and turn it around so that the female side (end with the center screw) is now facing to the outside. Re-assemble and tighten all nuts and bolts (See Illustration 6).

STEP 4:

Place two (2) - 1/2" jam nuts on stud and a 1/2" flat washer so that the distance between the end of the stud and the top of the washer is 3/4" (See Illustration 6). Tighten jam nuts together. Place wheel cover over stud (there should be 1/4" gap behind the cover) (See Illustrations 7). Before proceeding to Step 5, make sure wheel cover is centered and firmly against the wheel, if

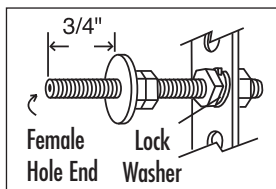

ILLUSTRATION 6

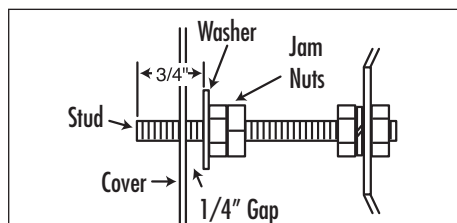

ILLUSTRATION 7

not, check jam nuts and flat washer, re-adjust as described above.

STEP 5A:

IF YOU ARE INSTALLING WING NUT - place flat washer over stud and screw wing nut on until tight. Next, install locking screw through top of wing nut and tighten with locking key.

Note: Tamper proof systems use left hand threaded locking screws.

STEP 5B:

If you are installing CENTER CAP - install 1/2" lock washer and nut over wheel cover and tighten securely. Next, place cap over stud and use locking key to secure locking screw to cover. **Note:** Tamper proof systems use left hand threaded locking screws.

ALWAYS KEEP YOUR LOCKING KEY IN YOUR VEHICLE. IF YOU LOSE YOUR KEY, CALL YOUR LOCAL DISTRIBUTOR OR REALWHEELS COVER CO. AT 1-800-982-1180.

FOOTNOTE:

For installing wheel covers with part numbers RW1020, 1021, 1024, 1025, 1120, & 1121. BEFORE PROCEEDING TO STEP 3 make sure Rubber Channels have been placed evenly around "outside rim" of wheel cover between rim & cover - See Illustration 3.

IMPORTANT NOTE:

PLACE A SMALL AMOUNT OF GREASE ON THE LOCKING SCREW BEFORE TIGHTENING. THIS WILL PREVENT THE LOCKING SCREW FROM CEASING UP IN THE STUD.

RealWheels Corporation • 3940 Tannahill Drive • Gurnee, IL 60031
847-662-7722 • Fax 847-662-7744 • www.realwheels.com • info@realwheels.com • toll-free 1-800-982-1180