

INSTALLATION OF RWG108 / RWG114 GRILLE OVERLAY FOR FREIGHTLINER 108SD/114SD MODELS

VERY IMPORTANT!— Read And Understand These Steps Before Installation.
There is not need to remove the grille from the truck.



Getting Started

The slats are numbered 1 thru 5 for the 114SD model and 1 thru 6 for the 108SD models (See Photo A). It is recommended that you test fit the stainless slats onto the grille before removing any double-sided tape. A Bend-Over Tool and Four Primer Sticks are included. **Note:** Leave plastic film on stainless slates to protect stainless finish during installation.

General Grille Slot Attachment Overview

These Stainless Steel Grille Slats attach to the black plastic grille with Bend-Over Tabs and 3M double-sided tape. To insure the Stainless Steel Grille Slats are secured to the areas were the double-sided tape is being used, we've provided 4 primer sticks to prime the black plastic slats in these areas. Additionally the Top Slat only has Two (2) Bend-Over Tabs and requires additional double-sided tape on each end.



Factory Installed Chrome Plastic Inserts

If your grille has factory installed chrome plastic inserts you may need to remove them in order for the new grille overlay to fit properly. This will be the case only if the accent pieces extend past the front of the face of the black grille.

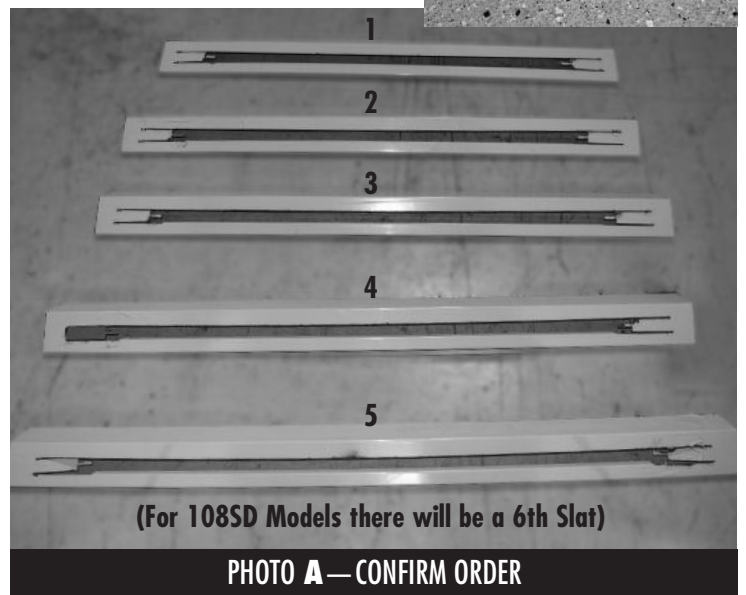

Continued On Next Page...



PHOTO 1 — CLEAN GRILLE

STEP 1 — Cleaning The Grille

Begin by cleaning the black plastic grille thoroughly with soap and water or Windex and a clean cloth. (See Photo 1).

STEP 2 — Priming The Top Slat Areas Of The Black Plastic Grille

Begin by measuring a 7" long area on the black plastic top slat of the plastic grille (See Photo 2A). Take the enclosed primer stick and squeeze the primer stick to get the primer flowing onto the brush end. Then on the 7" area previously measured coat the face of the black plastic grille (See Photo 2B). **Note:** Once the primer is applied, it dry's within a few seconds; however do not touch the primed areas after they have been primed.

Next measure a 10" long area just below the area previously coated (See Photo 2C). Coat this area with the primer stick brush as well (See Photo 2D). Repeat this process on the opposite side of the same black plastic top slat.

STEP 3 — Priming The Remaining Slat Areas Of The Black Plastic Grille

After these 4 areas are coated on the black plastic top slat, continue priming only the lower 10" area of the remaining black plastic slats with the additional primer sticks (See Photo 3).

STEP 4 — Installing the Top Stainless Slat

Begin by finding the top Stainless Steel Grille Slat. It will be marked by the number "1" and will have four pieces of double-sided tape on it (See Photo 4A). Next peel off the clear backing on the four pieces of double sided tape. (See Photo 4B)



PHOTO 2A — MEASURE



PHOTO 2B — PRIME

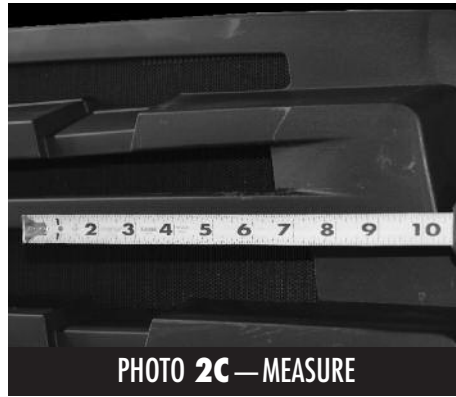

PHOTO 2C — MEASURE

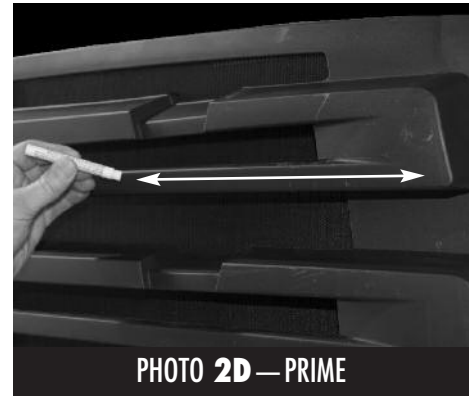

PHOTO 2D — PRIME

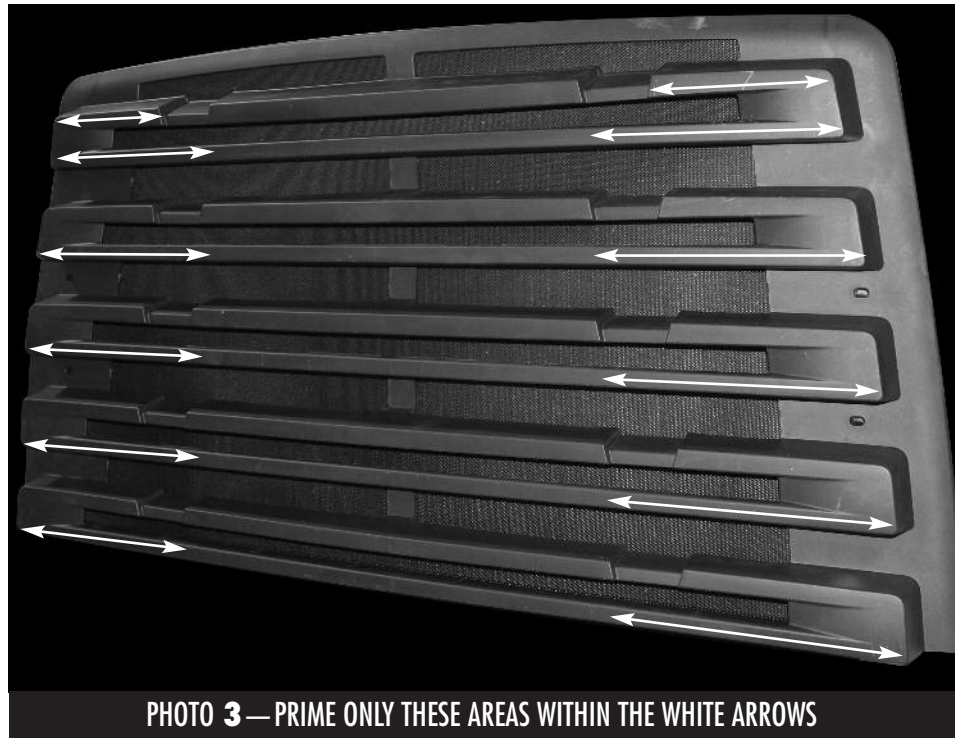

PHOTO 3 — PRIME ONLY THESE AREAS WITHIN THE WHITE ARROWS



PHOTO 4A — TOP STAINLESS STEEL GRILLE SLAT



PHOTO 4B — REMOVE CLEAR TAPE BACKING

STEP 4—Continued



PHOTO 4C— LOOSELY POSITION

Next loosely position the top slat onto the top black plastic grille slat (See Photo 4C).



PHOTO 4D— ALIGN TOP SLAT

Make sure the Stainless Steel Grille Slat is square and even on both ends (See Photo 4D).

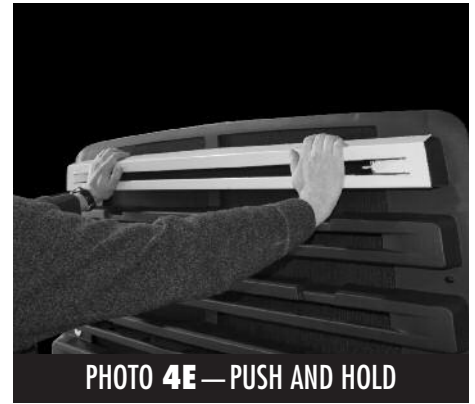

PHOTO 4E— PUSH AND HOLD

Once it is in place, push against the areas of Stainless Steel Slat where the double-side tape touches the black plastic grille and hold for a few seconds (See Photo 4E).



PHOTO 4F— PUSH BEND-OVER TABS

Next push the Bend-Over Tabs against the back of the recessed areas of the black plastic grille (See Photos 4F and 4G).

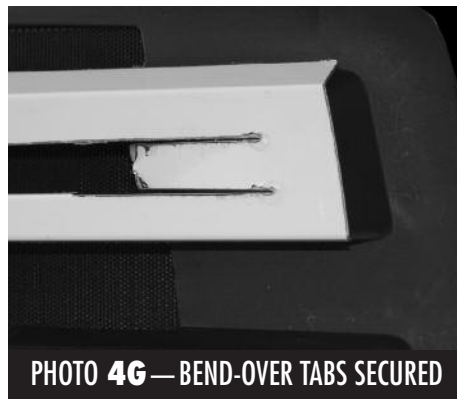

PHOTO 4G— BEND-OVER TABS SECURED

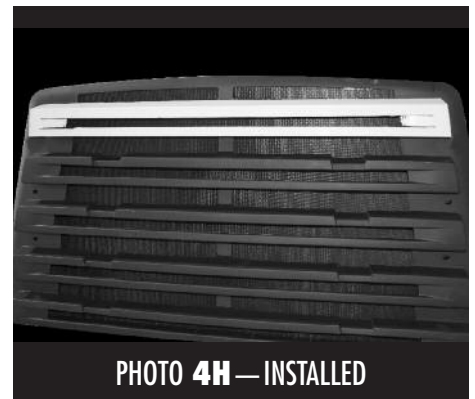

PHOTO 4H— INSTALLED

The top Stainless Steel Slat is now installed. (See Photo 4H)

STEP 5—Installing Stainless Slats 2 thru 5 (or 6 depending on model)

Find the Stainless Steel Slat marked with a Number 2 and remove the double-sided clear backing from the two pieces of tape (See Photos 5A & 5B).

Note: Stainless Steel Slat 2 through 5 (or 6), have only two pieces of double-sided tape plus six Bend-Over Tabs.

Next loosely position and place the Number 2 Stainless Steel Slat against the black plastic slat. (See Photo 5C).



PHOTO 5A— STAINLESS STEEL GRILLE SLATS 2–5 (OR 6)



PHOTO 5B— REMOVE CLEAR TAPE BACKING



PHOTO 5C— LOOSELY POSITION

Continued On Back...



PHOTO 5D — ALIGN SLAT

Make sure the Stainless Steel Grille Slat is square and even on both ends (See Photo 5D).

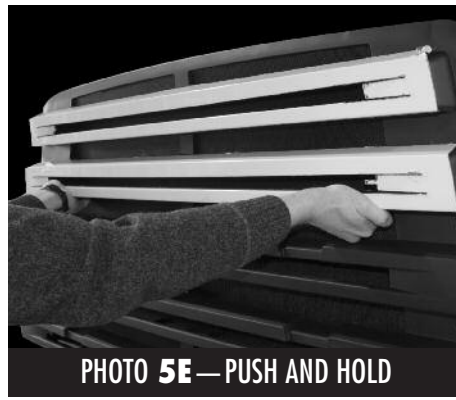

PHOTO 5E — PUSH AND HOLD

Once in place, push against the areas of Stainless Steel Slat where the double-side tape touches the black plastic grille and hold for a few seconds (See Photo 5E).



PHOTO 5F — BEND-OVER TOOL

A plastic Bend-Over Tool is included to assist in completely and securely bending over top tabs (See Photo 5F).



PHOTO 5G — POSITION BEND-OVER TOOL

Simply position Bend-Over Tool against tip of Bend-Over Tab (See Photo 5G).



PHOTO 5H — PUSH DOWN

Then using both hands to increase leverage, push Bend-Over Tab down and against the underside of the top section of the black plastic grille (See Photo 5H).



PHOTO 5I — REPEAT FOR OTHER TABS

Repeat the same process for all the top Bend-Over Tabs on the slat (See Photo 5I).

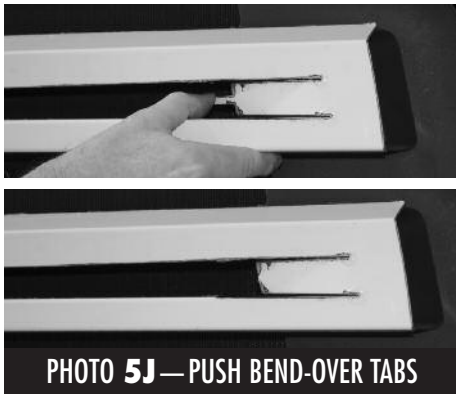

PHOTO 5J — PUSH BEND-OVER TABS

Next using your thumb, push the Bend-Over Tabs against the back of the recessed areas of the black plastic grille (See Photo 5J). Now the second slat is completely installed.



PHOTO 5K — ALL SLATS INSTALLED

Continue installing the remaining Stainless Steel Grill Slat in the correct order following the numbers indicated on the slats. At this point all Stainless Steel Grill Slat should be completely installed (See Photo 5K).

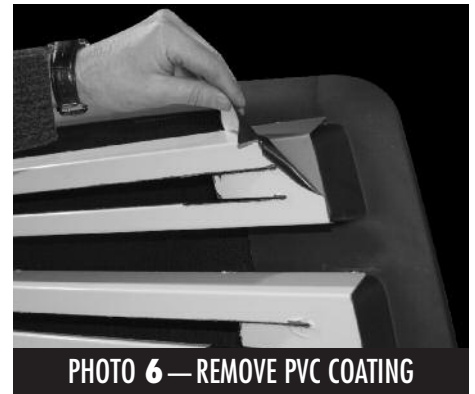

PHOTO 6 — REMOVE PVC COATING

STEP 6 — Removing PVC Coating

Finally remove all the white PVC protective coating from all the Stainless Steel Grill Slat. (See Photo 6). Any PVC residue can easily be removed with isopropyl alcohol and a soft cloth. You are now finished.