

IMPORTANT: Read And Understand All Instructions Before Installation • QUESTIONS? CALL 1-800-982-1180

BILLET ANTENNA SURROUND

Time To Install: Approx. 15 Minutes

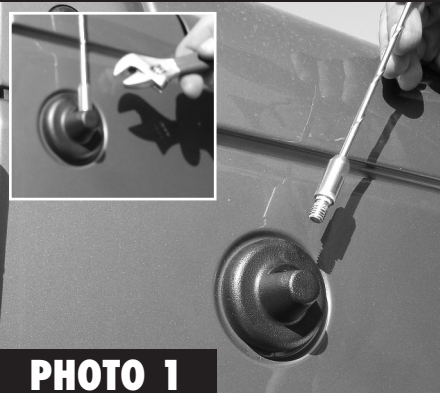

PHOTO 1

1. Using a small adjustable wrench, remove the antenna.



PHOTO 2

2. Extremely Important: Clean the area where the Antenna Surround is to be installed. If the area where the trim accessory is to be installed is not clean, dry, and free of any vinyl dressing, the trim accessory piece will not stick in place. Begin by cleaning the area thoroughly with a good non-residue cleaner such as Windex, or just clean thoroughly with soap and water and dry completely.
Note: Do not use the 3M Tape Primer as a cleaner.



PHOTO 3

3. Important: Prime only the plastic area where the Antenna Surround is to be installed. After the areas are completely cleaned and dry, you must then coat these plastic areas with 3M Tape Primer 94 (included). Thoroughly coat the cleaned area where the trim is to be installed with the Primer 94 and wait 5 minutes before installing the Trim Piece.

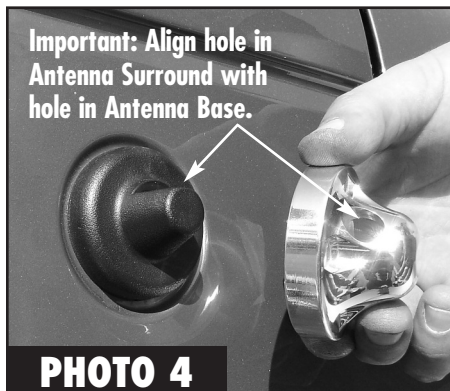

PHOTO 4

4. Position and Adhere the Antenna Surround. Before removing any heavy duty 3M Tape backing from the Trim Piece, loosely place it in position to verify how it will fit. Make sure the part lines up with any openings and fits side-to-side and top-to-bottom.
Important: Align hole in Antenna Surround with hole in Antenna Base. Next peel off all the paper from the double-sided tape on the back of the Trim Piece. Carefully place the Trim Piece in position. Push and hold firmly for a few seconds.



PHOTO 5A

5. Using a small adjustable wrench, replace the antenna.

6. You are now finished.



PHOTO 6A

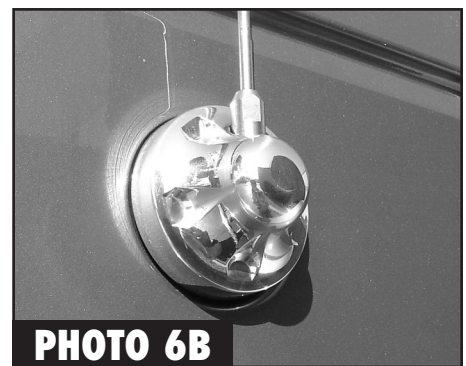

PHOTO 6B

RealWheels Corporation • 3940 Tannahill Drive • Gurnee, IL 60031

847-662-7722 • Fax 847-662-7744 • www.realwheels.com • info@realwheels.com • toll-free 1-800-982-1180